

karaoke NIGHT

KARAOKE MACHINE WITH LIGHTED STAGE MAT



**MODEL: KN290
USER MANUAL**

**USB FLASH
DRIVE**
COMPATIBLE

 **CAUTION: THIS IS NOT A TOY!** Not intended for use by children 8 years of age or younger.
Electrically Operated Product - Please use care when plugging into AC outlet.

FOR BEST USE: REMOVE SHOES BEFORE STEPPING ON THE MAT.
For further information on this model and the entire lineup of Karaoke Night products, please visit www.karaokenightusa.com

WARNING

Follow the advice below for safe operations.

1. Read these instructions.
2. Keep these instructions.
3. Heed all warnings.
4. Follow all instructions.
5. Do not use this apparatus near water.
6. Cleaning – Unplug this product from the wall outlet before cleaning. Do not use liquid cleaners or aerosol cleaners. Clean only with a dry cloth.
7. Do not install near any heat sources such as radiators, heat registers, stoves, or other apparatus (including amplifiers) that produce heat.
8. Only use attachments/accessories specified by the manufacturer.
9. This apparatus shall not be exposed to dripping or splashing water and that no object filled with liquids such as vases shall be placed on the mat or apparatus
10. Do not use this machine outdoor.
11. Stop operation immediately if any liquid or solid object should fall into the mat or cabinet.
12. Before use, check that the rated voltage of your unit matches your local voltage.
13. Ensure a minimum distance of 2 inches (5 cm) around the apparatus for sufficient ventilation.
14. Ensure that the ventilation is not impeded by covering the ventilation openings with items, such as newspapers, table cloths, curtains, etc.
15. Do not place naked flame sources, such as lighted candles on the apparatus.
16. Use the apparatus only in moderate climates.
17. Do not expose the AC/DC adaptor and apparatus to dripping or splashing.
18. The AC/DC adaptor of apparatus should not be obstructed and should be easily accessed during intended use.
19. To be completely disconnected from the power input, the AC/DC adaptor of apparatus should be disconnected from the mains.
20. If the unit is not to be used for a long period of time, make sure that all power sources are disconnected from the unit. Unplug the AC adapter from the wall outlet. Make it a practice to remove the AC adapter by grasping the plastic body and not by pulling the cord.

Should any trouble occur, disconnect the AC Adapter and refer servicing to qualified personnel.

COMPLIANCE WITH FCC REGULATIONS

This device complies with Part 15 of the FCC Rules. Operation is subject to the following two conditions:

- (1) this device may not cause harmful interference, and
- (2) this device must accept any interference received, including interference that may cause undesired operation.

NOTE: This equipment has been tested and found to comply with the limits for a Class B digital device, pursuant to Part 15 of the FCC Rules. These limits are designed to provide reasonable protection against harmful interference in a residential installation. This equipment generates, uses and can radiate radio frequency energy and, if not installed and used in accordance with the instructions, may cause harmful interference to radio communications. However, there is no guarantee that interference will not occur in a particular installation. If this equipment does cause harmful interference to radio or television reception, which can be determined by turning the equipment off and on, the user is encouraged to try to correct the interference by one or more of the following measures:

- Reorient or relocate the receiving antenna.
- Increase the separation between the equipment and receiver.
- Connect the equipment into an outlet on a circuit different from that to which the receiver is connected.
- Consult the dealer or an experienced radio/TV technician for help.

CAUTION: Changes or modifications not expressly approved by the party responsible for compliance could void the user's authority to operate the equipment.

PROTECT YOUR FURNITURE!!

This system is equipped with non-skid rubber 'feet' to prevent the product from moving when you operate the controls. These 'feet' are made from non-migrating rubber material specially formulated to avoid leaving any marks or stains on your furniture. However certain types of oil based furniture polishes, wood preservatives, or cleaning sprays may cause the rubber 'feet' to soften, and leave marks or a rubber residue on the furniture. To prevent any damage to your furniture we strongly recommend that you purchase small self-adhesive felt pads, available at hardware stores and home improvement centers everywhere, and apply these pads to the bottom of the rubber 'feet' before you place the product on fine wooden furniture.

DEAR KARAOKE NIGHT CUSTOMER

Selecting fine audio equipment such as the unit you've just purchased is only the start of your musical enjoyment. Now it's time to consider how you can maximize the fun and excitement your equipment offers. This manufacturer and the Electronic Industries Association's Consumer Electronics Group want you to get the most out of your equipment by playing it at a safe level. One that lets the sound come through loud and clear without annoying blaring or distortion and, most importantly, without affecting your sensitive hearing. Sound can be deceiving. Over time your hearing "comfort level" adapts to higher volumes of sound. So what sounds "normal" can actually be loud and harmful to your hearing. Guard against this by setting your equipment at a safe level BEFORE your hearing adapts.

To establish a safe level:

- Start your volume control at a low setting.

- Slowly increase the sound until you can hear it comfortably and clearly, and without distortion.

Once you have established a comfortable sound level:

- Set the dial and leave it there.

Taking a minute to do this now will help to prevent hearing damage or loss in the future. After all, we want you listening for a lifetime.

We Want You Listening For a Lifetime

Used wisely, your new sound equipment will provide a lifetime of fun and enjoyment. Since hearing damage from loud noise is often undetectable until it is too late, this manufacturer and the Electronic Industries Association's Consumer Electronics Group recommend you avoid prolonged exposure to excessive noise.



Customer's Record:

The serial number of this product is found on its bottom. You should note the serial number of this unit in the space provided as a permanent record of your purchase to aid in identification in the event of theft or loss.

Model Number: KN290

Serial Number : _____

CONTENTS OF YOUR PRODUCT

KN290 Karaoke Machine	x 1 set
Lighted Stage Mat	x 1 pc
Aux In Cable (1.5 m / 4.9 feet)	x 1 pc
Microphone with Cable (3 m / 10 feet)	x 2 pcs
AC Adapter (DC 12 V \equiv 1.5 A output)	x 1 pc
User Manual	x 1 pc

INTRODUCTION

Before using your unit, please glance through this manual to familiarize yourself with all the features available and the sections of the manual that describe their operations. Next go to the section for the specific operation you wish to perform.

For your easy reference, listed here are some of the main features of this System.

Lighted Stage Mat – allows you singing & dancing on it like a popular singer.

Dance beat pedal – lets you select one of 3 dance beats.

Applause sound effect pedal – lets you select one of 2 applause sound effects.

Built-in Speakers - let you share the music with your family or friends.

Light Show – Exciting LED disco style light show on the 4 sides of stage mat.

USB Port – Lets you connect to your USB thumb drive for playing MP3 audio.

INSTALLATION



CAUTION:

- This product contains small parts. Only adults should install this product.
- The Tablet /Smartphone Holder and Stand are designed for light weight and small size tablets only.

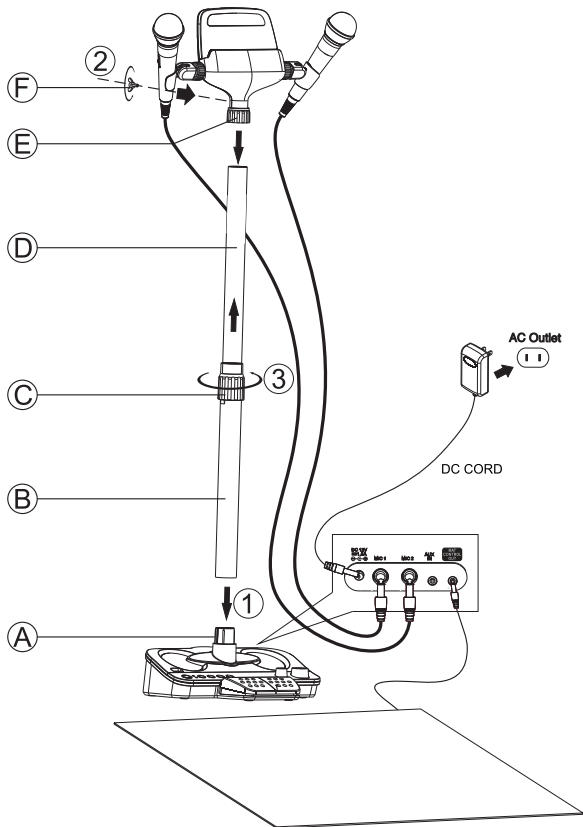

1. Carefully remove all packing materials to find parts below for assembly.
 - A. Microphone stand and base Connector
 - B. Microphone stand (wider outer pole)
 - C. Height adjusting knob
 - D. Microphone stand (upper pole)
 - E. Microphone holder and cradle connector
 - F. Fixing screw
 - G. Main Unit Base

2. Fully insert the Microphone stand (wider outer pole) into the base connector ①
3. Fully insert the cradle connector into the Microphone stand (upper pole) and fix it by fixing screw (included) ②.
4. Turn the height adjusting knob in counter-clockwise direction to loosen the joint, then move upper pole up and down to adjust the microphone stand to desired height.
Notes: 1.) For your safety, please do not insert your tablet or smartphone into the Tablet/Smartphone holder to avoid accidental falling during stand height adjustment.
 2.) Use one hand to hold upper pole of microphone stand ④ while using the other hand to loosen the knob ③ to avoid sudden falling of upper pole assembly.
5. After stand height is set, tighten it up by turning the height adjusting knob in clockwise direction ③.
6. Move the unit to the location you want to play and connect accessories by following operations in the user manual.

WARNING: - When moving the unit to other locations, please use both hands to hold the base. Do not grip the mic stand to move the unit. If you do, the heavy base may accidentally fall to the ground which may result in damage. This will void the warranty.

LOCATION OF CONTROLS

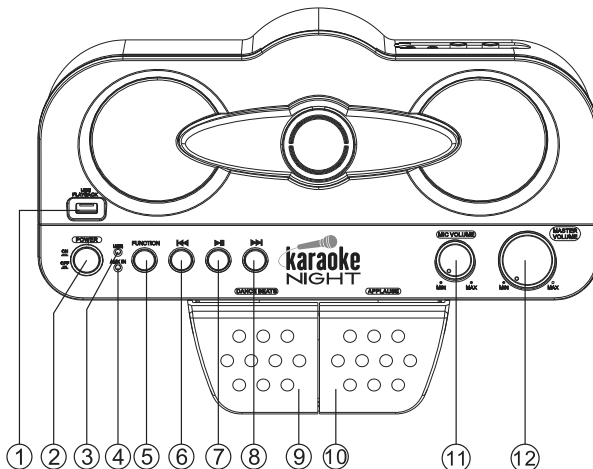

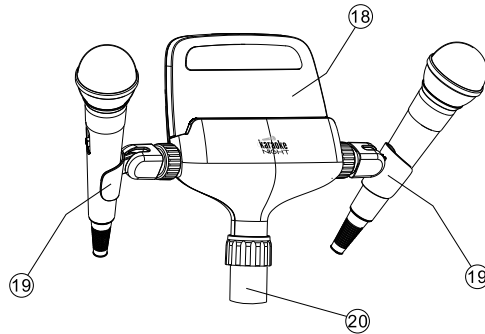
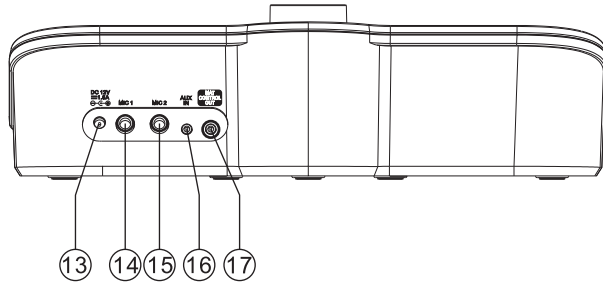

- | | |
|---------------------------------------|----------------------------------|
| 1. USB Playback Port | 11. Mic. Volume Control Knob |
| 2. Power ON/OFF Button with indicator | 12. Master Volume Control Knob |
| 3. USB Mode Indicator | 13. DC 12V Input Jack |
| 4. AUX IN Mode Indicator | 14. Mic.1 Input Jack |
| 5. FUNCTION Button | 15. Mic.2 Input Jack |
| 6. ⏮ Skip Backward Button | 16. AUX IN Jack |
| 7. ⏸ Play / Pause Button | 17. Mat Control Out Connector |
| 8. ⏭ Skip Forward Button | 18. Tablet/Smartphone Holder |
| 9. Left Pedal | 19. Mic Holders |
| 10. Right Pedal | 20. Height adjustable Mic Stand. |

POWER SOURCES

AC OPERATION

Plug the supplied AC adapter into the DC jack (12V DC input) on the rear panel of the unit and connect to a standard AC wall socket. Press the POWER ON/OFF button on the Karaoke system to turn on and the POWER INDICATOR will light.

Note: When the unit is not operated for long periods of time, unplug the AC adapter from the unit and wall outlet.

REAR SIDE OF MAIN UNIT

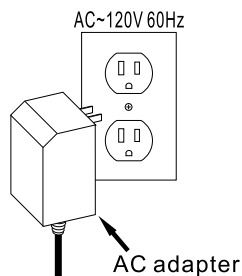
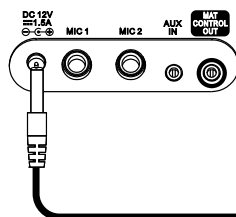

CONNECTING LIGHTED STAGE MAT

WARNING - Please ensure the floor that you are going to use the lighted stage mat on is completely dry to avoid slipping.

To prevent the lighted stage mat from getting damaged:

- To keep away from water.
- Do not step on the LED strip surrounding 4 sides of mat.
- Do not fold the LED strip.
- Take off shoes before you step on the mat.

1. Plug the lighted stage mat into the MAT CONTROL OUT connector at rear panel of the base.
2. LED surrounding 4 sides of the mat will be lighting and changing with the music.

Note: If the brightness is glaring, turn on room lights.

CONNECTING THE MICROPHONE

WARNING - Tapping or dropping the microphone while it is on can permanently damage your microphone. Do not swing the microphone around by the cord.

Note: To prevent feedback or whistling from occurring, please be sure that the microphone is not too close to unit's speaker. Turn the ON/OFF switch located on the Microphone to the OFF position when you put the microphone into Mic Holder.

REAR SIDE OF MAIN UNIT

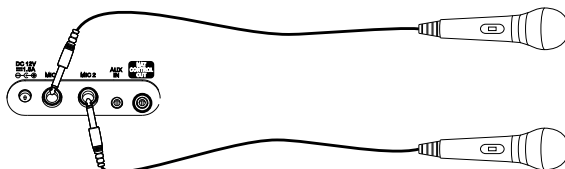

1. Connect the supplied Microphone to either one of the MIC input jacks.
2. Press the POWER ON/OFF button to turn on the unit, the POWER INDICATOR will light.
3. Slide the ON/OFF switch located on the Microphone to the ON position and speak or

sing into the Microphone. The Microphone sensitivity and loudness can be adjusted as required by turning the MIC VOLUME control and/or MASTER VOLUME control.

4. Turn off the unit after use by pressing the POWER ON/OFF button again. The POWER INDICATOR will go off. Place the microphone (s) in the Mic Holder (s) of the stand.

USING AUX IN FUNCTION

This feature allows you to plug a tablet or smartphone (both not included) which contains downloaded music and lyrics for Karaoke singing.

1. Place your external device in the Tablet/Smartphone Holder on Mic Stand.
2. Plug a 3.5mm audio cable (included) into the headphone jack of your tablet or smartphone and connect the other end (3.5mm plug) into the AUX IN jack on the rear side of this unit.

WARNING - Please take extra care when plugging your external device into the AUX IN jack. Do not accidentally plug into the MAT CONTROL OUT connector. Doing so may cause damage to your device.

3. Press the POWER button to turn on the unit, POWER INDICATOR will light. Turn on your external device as well.
4. Tap the FUNCTION button to select AUX mode, AUX IN LED indicator will turn on steadily.
5. Select a Karaoke song stored in your tablet or smartphone to play. Slide the ON/OFF switch located on the Microphone to the ON position and speak or sing into the Microphone. The Microphone sensitivity and loudness can be adjusted as required by turning the MIC VOLUME control and/or MASTER VOLUME control.

WARNING - Do not use excessive force to tap your tablet or smartphone screen when it's placed in the Tablet/Smartphone Holder. It may result in the stand accidentally falling down and causing damage to your external device.

6. Adjust the volume control of your audio player and then the MASTER VOLUME CONTROL of the unit to obtain the desired audio sound level.
7. Turn off both the external audio player and this unit after use, unplug the audio cable from AUX IN jack.

EXAMPLE OF EXTERNAL TABLET/SMART PHONE

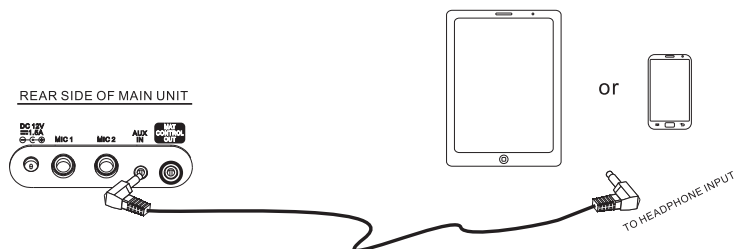

USB OPERATION

The system is able to decode and playback MP3 files which are stored in the memory media with USB thumb drive.

Note: If music stored in your USB thumb drive does not conform to the MP3 standard, it may not play properly.

1. Plug-in the USB plug and make sure it is inserted completely.

Note: Connecting the USB upside down or backwards could damage the audio system or the storage media of USB thumb drive. Check to be sure the direction is correct before connection.

2. Press the POWER button to turn on the unit, tap the FUNCTION button to select USB mode.
3. The USB mode indicator will light and flash, unit starts to play songs stored in USB thumb drive automatically.

● PLAY / PAUSE button ►||

- Press the PLAY/PAUSE ►|| button once to pause the music playback, USB mode indicator lights steadily. Press it again to resume music playback, USB mode indicator flashes.

● SKIP UP ►► / SKIP DOWN ◀◀ button

- During MP3 music playback, tap the ►► button once to skip to the next track.
- During MP3 playback, tap the ◀◀ button once to skip to the previous track.

4. Adjust the MASTER VOLUME CONTROL of the unit to obtain the desired audio sound level.
5. USB mode defaults in repeat All tracks playback, press the POWER button to turn off the unit after using, POWER INDICATOR goes off.

REMARKS

- If connecting the system to MP3 player via the USB port, due to variances in MP3 encoding format, some MP3 players may not be able to play via the USB port. This is not a malfunction of the system.
- There are numerous USB thumb drive producers. Solutions and formats are variable between each other. Therefore, we do not guarantee this unit can support all USB thumb drive from every brand.
- USB thumb drives supported: Support FAT 32 format, 1 GB - 64 GB maximum.

BUILT IN SOUND EFFECTS

Dance beats

- Step on the PEDAL 1 once, a built in dance beat can be heard from speaker. Step on the PEDAL 1 again to change to another dance beat. There are 3 built in dance beats.
- To turn off dance beat, step on the PEDAL 1 repeatedly until no dance beat comes from speaker.

Applause sound effects

- Step on the PEDAL 2, a built in applause sound effect can be heard from speaker. Step on the PEDAL 2 again to change to another applause sound effect. There are 2 built in applause sounds.
- To turn off applause sound effect, tap the PEDAL 1 repeatedly until no dance beat comes from speaker.

RESETTING THE UNIT

If the system does not respond or exhibits erratic or intermittent operation, you may have experienced an electrostatic discharge (ESD) or a power surge that triggered the internal microcontroller to shut down automatically. If this occurs, simply disconnect the AC Adapter. Wait for at least 3 minutes and then setup the unit again as if you were using it for the very first time.

CARE AND MAINTENANCE

1. Children should be supervised when using this appliance.
2. Never wrap the microphone lead around any animal or person. Special care should be taken with long wires.
3. Clean your unit with a damp (never wet) cloth. Solvent or detergent should never be used.
4. Avoid leaving your unit in direct sunlight or in hot, humid or dusty places.
5. Keep your unit away from heating appliances and sources of electrical noise such as fluorescent lamps or motors.

TROUBLESHOOTING GUIDE

PROBLEM	POSSIBLE CAUSE	SOLUTION
No power when plugged in	AC adapter is not plugged into the AC outlet.	Insert the AC adapter into the AC outlet.
	The AC outlet may not have power.	Check the outlet with a working lamp or other electrical appliance.
No sound	MASTER VOLUME control is set to minimum.	Turn up the master volume.
	Unit is in different operation mode.	Press the FUNCTION button to select AUX or USB mode correctly.
USB port does not work normally	USB thumb drive is not inserted properly.	Insert the USB thumb drive properly and firmly
	USB thumb drive is not support in this system.	Try some USB thumb drives which can be supported in this system
	No playable file.	Make sure your USB thumb drive has playable files in MP3 format.
Cannot sing through the mic	Improper mic volume control.	Adjust MIC and MASTER volume level controls to appropriate levels.
	Mic is off.	Turn on mic with the ON/OFF switch located on the microphone.
	Mic is not properly plugged in.	Insert the mic plug into either MIC 1 or MIC 2 jack of the unit properly.

SPECIFICATIONS

Audio Output Power	: 2 X 2 W (RMS)
USB port	: Support FAT 32 format, 1 GB - 64 GB maximum USB thumb drives
Aux In Jack	: 1 x 3.5 mm
Microphone Inputs	: 2 x 600 ohms Impedance with 6.3 mm jack
Microphone	: 2 x Dynamic Microphone
Power Source	: AC Adapter: Input AC 120V~ 60Hz 0.8A Output DC 15 V===1.5A ⊖⊕

Due to continuing improvement, the features and the design are subject to change without notice.

Karaoke Night products are designed and engineered by Marino Andriani, LLC

90 DAY LIMITED WARRANTY AND SERVICE VALID IN THE U.S.A. ONLY

SPECTRA MERCHANDISING INTERNATIONAL, INC. warrants this unit to be free from defective materials or factory workmanship for a period of 90 days from the date of original customer purchase and provided the product is utilized within the U.S.A. This warranty is not assignable or transferable. Our obligation under this warranty is the repair or replacement of the defective unit or any part thereof, except batteries, when it is returned to the SPECTRA Service Department, accompanied by proof of the date of original consumer purchase, such as a duplicate copy of a sales receipt.

You must pay all shipping charges required to ship the product to SPECTRA for warranty service. If the product is repaired or replaced under warranty, the return charges will be at SPECTRA's expense. There are no other express warranties other than those stated herein.

This warranty is valid only in accordance with the conditions set forth below:

1. The warranty applies to the SPECTRA product only while:
 - a. It remains in the possession of the original purchaser and proof of purchase is demonstrated.
 - b. It has not been subjected to accident, misuse, abuse, improper service, usage outside the descriptions and warnings covered within the user manual or non-SPECTRA approved modifications.
 - c. Claims are made within the warranty period.
2. This warranty does not cover damage or equipment failure caused by electrical wiring not in compliance with electrical codes or SPECTRA user manual specifications, or failure to provide reasonable care and necessary maintenance as outlined in the user manual.
3. Warranty of all SPECTRA products applies to residential use only and is void when products are used in a nonresidential environment or installed outside the United States.

This warranty gives you specific legal rights, and you may also have other rights which vary from state to state. TO OBTAIN SERVICE please remove all batteries (if any) and pack the unit carefully and send it freight prepaid to SPECTRA at the address shown below. IF THE UNIT IS RETURNED WITHIN THE WARRANTY PERIOD shown above, please include a proof of purchase (dated cash register receipt) so that we may establish your eligibility for warranty service and repair of the unit without cost. Also include a note with a description explaining how the unit is defective. A customer service representative may need to contact you regarding the status of your repair, so please include your name, address, phone number and email address to expedite the process.

IF THE UNIT IS OUTSIDE THE WARRANTY PERIOD, please include a check for **\$80** to cover the cost of repair, handling and return postage. All out of warranty returns must be sent prepaid.

It is recommended that you contact SPECTRA first at 1-800-777-5331 or by email at custserv@spectrainl.com for updated information on the unit requiring service. In some cases the model you have may be discontinued, and SPECTRA reserves the right to offer alternative options for repair or replacement.

SPECTRA MERCHANDISING INTERNATIONAL, INC.
4230 North Normandy Avenue,
Chicago, IL 60634, USA.
1-800-777-5331

To register your product, visit the link on the website below to enter your information.
<http://www.spectrainl.com/wform.htm>

0816

Printed in China