



## BLUETOOTH KARAOKE SMART MICROPHONE



KN60SM  
USER MANUAL



**PLEASE READ THIS USER MANUAL COMPLETELY BEFORE OPERATING  
THIS UNIT AND RETAIN THIS BOOKLET FOR FUTURE REFERENCE.**

For further information on this model and the entire lineup of Karaoke Night products, please visit [www.karaokenightusa.com](http://www.karaokenightusa.com)

## COMPLIANCE WITH FCC REGULATIONS

**FCC ID : 2AEBZKN0SM-K**

This device complies with Part 15 of the FCC Rules. Operation is subject to the following two conditions:

- (1) this device may not cause harmful interference, and
- (2) this device must accept any interference received, including interference that may cause undesired operation.

**NOTE:** This equipment has been tested and found to comply with the limits for a Class B digital device, pursuant to Part 15 of the FCC Rules. These limits are designed to provide reasonable protection against harmful interference in a residential installation. This equipment generates, uses and can radiate radio frequency energy and, if not installed and used in accordance with the instructions, may cause harmful interference to radio communications. However, there is no guarantee that interference will not occur in a particular installation. If this equipment does cause harmful interference to radio or television reception, which can be determined by turning the equipment off and on, the user is encouraged to try to correct the interference by one or more of the following measures:

- Reorient or relocate the receiving antenna.
- Increase the separation between the equipment and receiver.
- Connect the equipment into an outlet on a circuit different from that to which the receiver is connected.
- Consult the dealer or an experienced radio/TV technician for help.

**CAUTION:** Changes or modifications to this equipment not expressly approved by the party responsible for compliance could void the user's authority to operate the equipment.

## DEAR KARAOKE NIGHT CUSTOMER

Selecting fine audio equipment such as the unit you've just purchased is only the start of your musical enjoyment. Now it's time to consider how you can maximize the fun and excitement your equipment offers. This manufacturer and the Electronic Industries Association's Consumer Electronics Group want you to get the most out of your equipment by playing it at a safe level. One that lets the sound come through loud and clear without annoying blaring or distortion and, most importantly, without affecting your sensitive hearing.

Sound can be deceiving. Over time your hearing "comfort level" adapts to higher volumes of sound. So what sounds "normal" can actually be loud and harmful to your hearing. Guard against this by setting your equipment at a safe level BEFORE your hearing adapts.

### To establish a safe level:

- Start your volume control at a low setting.
- Slowly increase the sound until you can hear it comfortably and clearly, and without distortion.

### Once you have established a comfortable sound level:

- Set the dial and leave it there.  
Taking a minute to do this now will help to prevent hearing damage or loss in the future. After all, we want you listening for a lifetime.

### We Want You Listening For a Lifetime

Used wisely, your new sound equipment will provide a lifetime of fun and enjoyment. Since hearing damage from loud noise is often undetectable until it is too late, this manufacturer and the Electronic Industries Association's Consumer Electronics Group recommend you avoid prolonged exposure to excessive noise.



### Customer's Record:

The serial number can be found on the back of the speaker and microphone. You should note the serial number of this unit in the space provided as a permanent record of your purchase to aid in identification in the event of theft or loss.

**Model Number: KN60SM**

**Serial Number :** \_\_\_\_\_

## CONTENTS OF YOUR PRODUCT

Bluetooth Karaoke Smart Microphone	x 1 pc
Speaker Unit	x 1 pc
AUX IN Cable	x 1 pc
USB Audio In Cable	x 1 pc
Micro USB Charging Cable	x 1 pc
Stereo Earbuds	x 1 pc
User Manual	x 1 pc

## INTRODUCTION

This Bluetooth Karaoke Smart Microphone has a compact design and is full of interesting features yet it is easy to use. Just follow a few simple instructions and you will become an experienced karaoke singer in no time. Before using this product, please read this manual to familiarize yourself with all the features available. Next, go to the section that details the operation you wish to perform.

For your reference, listed here are some of the main features of this Bluetooth Karaoke Smart Microphone.

1. KTV Effect  
Stereo, live-sound effect, distinguishing the rhythm and intonation automatically.
2. Echo Effect  
Add excellent echo effect to your performance as desired.
3. Bluetooth connection  
Supporting all Bluetooth wireless devices and transmitting stereo audio to speaker unit when you sing.
4. Built-in rechargeable batteries  
The smart Microphone and Speaker units are each equipped with a built-in Li-polymer battery for portability and extended playing time. When battery is low, they can be conveniently recharged with a standard USB port of your PC, an external 1 Amp USB AC adaptor or a portable power bank with DC5V output.
5. System compatibility  
Compatible with iOS, MAC OS X, Windows and Android.
6. Sing karaoke anytime, anywhere with your smartphone  
Download KTV/Karaoke app(s) from Apple App store or Android Google Play.

## LOCATION OF CONTROLS

### KARAOKE SMART MICROPHONE

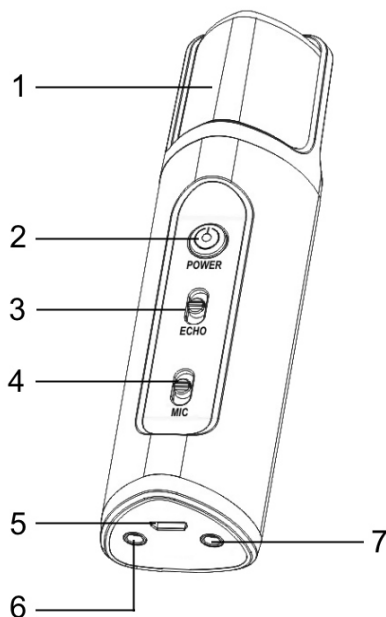

### SPEAKER UNIT

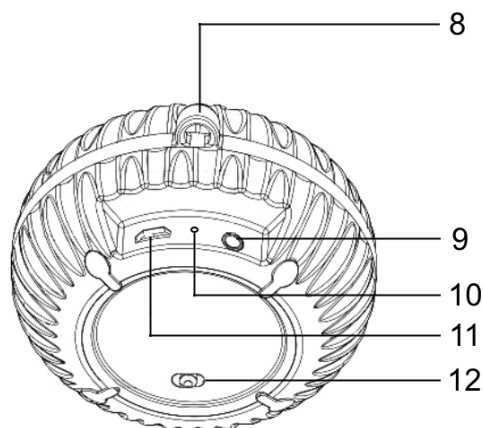

## KARAOKE SMART MICROPHONE

1. MICROPHONE
2. POWER BUTTON WITH BT STATUS/CHARGING/POWER INDICATOR
3. ECHO EFFECT CONTROL
4. MIC VOLUME CONTROL
5. USB CHARGING PORT (DC5V IN) / AUDIO IN
6. AUDIO OUT 1
7. AUDIO OUT 2

## SPEAKER UNIT

8. HANGER OPENING
9. AUX IN JACK
10. POWER INDICATOR
11. USB CHARGING INPUT
12. POWER ON/OFFSWITCH

## POWER SOURCE

Both the Microphone and Speaker units each operate on a non-removable, built-in Li-polymer battery. Before first use, please charge them for at least 4 hours as they are not fully charged when leaving the factory.

## CHARGING INSTRUCTIONS

Both the Microphone and Speaker units are equipped with a micro USB connector for battery charging. A micro USB cable is also included for your convenience.

### CHARGING THE MICROPHONE BATTERY WITH A USB PORT OF YOUR PC OR A USB ADAPTOR

1. We recommend charging the Microphone battery for a minimum of 4 hours prior to first use.
2. Connect the USB Charging Cable to a standard USB port on your desktop PC or an external USB adaptor with DC5V output (not included) using the provided micro USB cable.
3. When charging the Microphone, the Charging Indicator will light in red and turn off when the battery is fully charged. Unplug the USB cable from the power source once the battery is fully charged.
4. After prolonged use, the battery will become exhausted and operation might become intermittent. When this happens, please recharge the microphone battery as soon as possible.

### CHARGING THE SPEAKER BATTERY WITH A USB PORT OF YOUR PC OR A USB ADAPTOR

1. We recommend charging the Speaker battery for a minimum of 4 hours prior to first use.
2. Connect the USB Charging Cable to a standard USB port on your desktop PC or an external USB adaptor with DC5V output (not included) using the provided micro USB cable.
3. When charging the Speaker, the Charging Indicator will light in red and turn off when the battery is fully charged. Unplug the USB cable from the power source once the battery is fully charged.
4. After prolonged use, the battery will become exhausted and sound quality might become distorted. When this happens, please recharge the speaker battery as soon as possible.

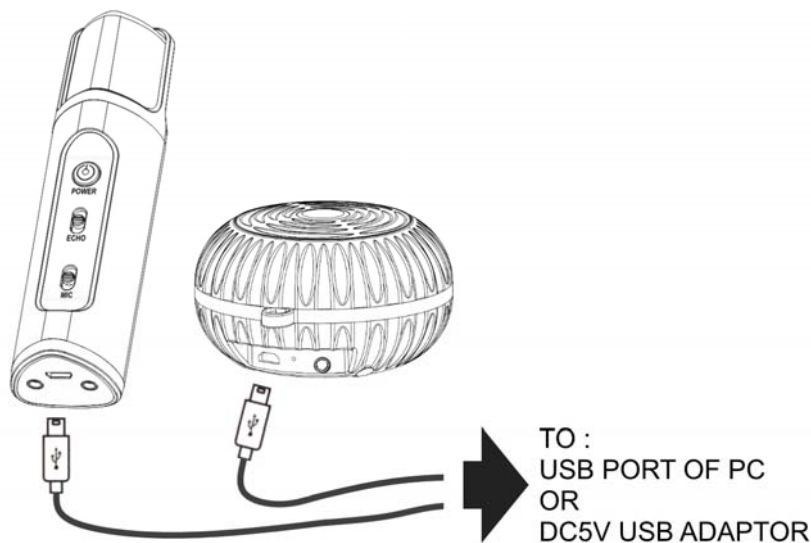

### Notes:

1. Charging time will vary if you are listening to music while charging the speaker battery. We recommend you switch off the speaker power during the charging process or until the speaker battery is fully charged.

2. To prolong the life of a rechargeable battery, it is recommended to completely discharge it before fully charging it again.
3. Rechargeable batteries need to be cycled a few times for maximum performance and longer battery life. If you don't use the unit often, recharge the battery at least once a month in order to keep the internal battery working properly.



### Battery Note and Care

- Do not burn or bury batteries.
- Do not puncture or crush.
- Do not disassemble.
- Recycle Li-polymer batteries. Do not dispose of in the trash.
- Use only chargers rated for Li-polymer cells. Be sure the charger's voltage and current settings are correct for the battery pack being charged.
- Charge batteries on a fireproof surface away from flammable items or liquids.
- Batteries should NEVER be left unattended while charging. Only adults should charge the batteries.
- Follow the manufacturer's instructions for charging the product and do not charge longer than recommended. Unplug the charger when the battery is charged or not in use.

## OPERATING INSTRUCTIONS

### PREPARING TO SING

Before using the product for singing, you will need to:

1. Connect the Bluetooth Microphone wirelessly to your Bluetooth enabled smart device via Bluetooth or connect to a MP3/MP4 player using the provided USB Audio In Cable.
2. Your smart device or MP3/MP4 Player may be preloaded with compatible music or Karaoke files that you want to sing.
3. Otherwise, your smart device should be connected to the internet and have your KTV/Karaoke app(s) properly installed. Examples of such apps on the Apple App Store and Android Google Play include "The Voice", "Star Maker", "Red Karaoke", "Yokee" and many more.
4. For private listening, insert the plug of the included stereo earbuds to the AUDIO OUT1 or OUT2 jack.
5. For public performances, insert the plug of the included AUX IN cable to the AUDIO OUT1 or OUT2 jack of the Mic and the AUX IN jack of the Speaker unit or an external amplifier (not included).
6. Use the MIC VOLUME CONTROL to adjust the output level of your voice.
7. Use the ECHO EFFECT CONTROL to adjust the ECHO level of your voice to suit the style of the song you are singing.
8. To turn OFF the Mic, press the POWER button once and the indicator light goes OFF. Do not forget to turn OFF the Bluetooth feature on your device as well.

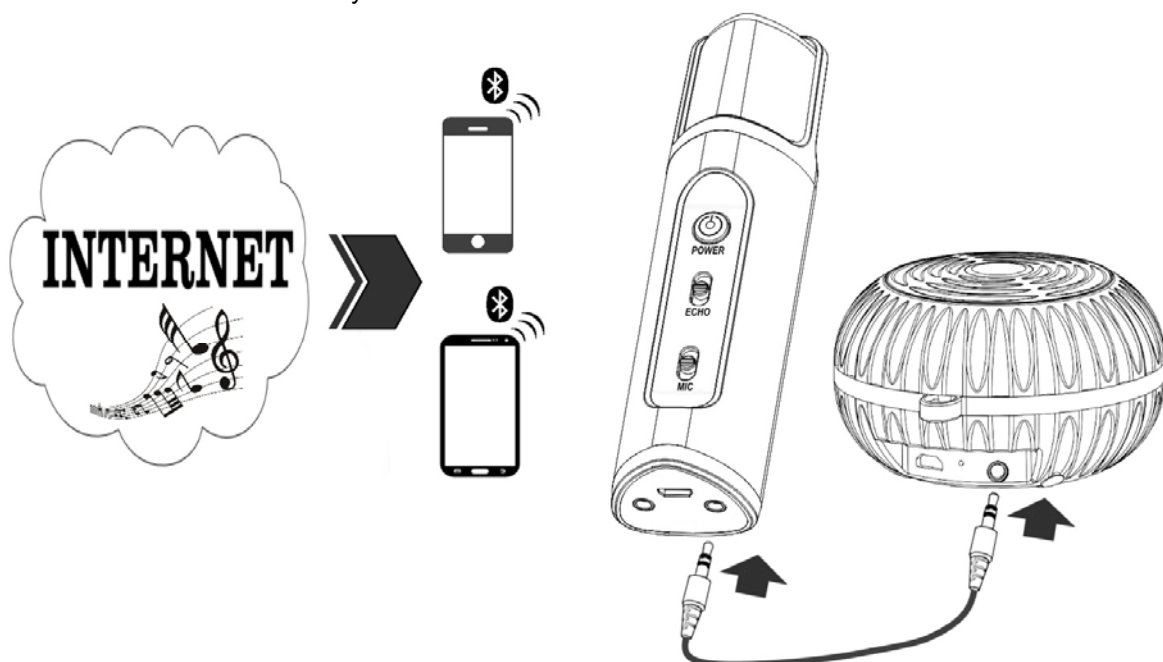

**NOTE:** This speaker is not magnetically shielded and may cause color distortion on the screen of some TVs or video monitors. To avoid this, you may need to move the speaker further away from the TV or monitor if unnatural color shifts or image distortion occurs.

#### CONNECTING AND PAIRING THE MIC TO YOUR BLUETOOTH SMART DEVICE

Press the **POWER** button to turn on the Bluetooth Mic.

If the Mic has never been paired with a Bluetooth enabled device before, you need to follow the pairing instructions below to link the Mic with your Bluetooth device.

1. When the Mic is ON, its **BLUETOOTH STATUS INDICATOR** will light in blue in the upper half and flash in green rapidly in the lower half indicating it has entered the search and pairing mode.
2. Turn on the Bluetooth feature of your smart device and enable the search or scan mode to find the Mic.
3. Select "KN60SM" from the active device list when it appears on your device screen. If your device requests a password, enter the default password "0000" or "1234" to pair the Mic with your device. If pairing is successful, the **BLUETOOTH STATUS INDICATOR** will light in solid blue with a slow flashing green light.

**Remarks:**

- ◆ After initial pairing, the unit will stay paired unless unpaired manually by the user or erased due to a reset of the device. If your Bluetooth device should become unpaired or you find it is unable to connect, repeat the above steps to start the pairing process again.
  - ◆ The Mic may automatically reconnect to a previously linked device that is in range so you may need to turn off the Bluetooth on that previously paired device first before going through the above steps.
  - ◆ If the **POWER** button of the Bluetooth Mic is accidentally turned OFF, the Bluetooth Mic may not reconnect to your connected Bluetooth smart device automatically even after it is turned ON again. If that happens, please open the Bluetooth menu of your smart device and select "KN60SM" to reconnect it again.
4. Using built-in controls on your Bluetooth device, you can play the stored music or Karaoke files from your smart device or Karaoke songs available in your app wirelessly to the Mic.

**❗ IMPORTANT NOTES FOR IPHONE AND IPAD USERS:**

Due to constraints of the iOS system, the audio signals transmitted by the Bluetooth Mic cannot be recorded onto your iPhone/iPad. To overcome this issue, you must connect the provided USB Audio In Cable to the micro USB AUDIO IN jack of the Mic and the headphone jack of your iPhone or iPad when you are in Bluetooth connection mode. Please see next section for details on USB Audio In Cable connection.

**NOTES:**

- ◆ Refer to manual of your smartphone, iPhone, iPad, computer or other Bluetooth enabled device for Bluetooth operation since it may vary from model to model.
- ◆ Your Bluetooth enabled device will not play the music to the Speaker or Earbuds via the Mic if the device does not support the A2DP Bluetooth profile.

## CONNECTING TO A SMARTPHONE/iPHONE/iPAD USING THE USB AUDIO IN CABLE



If your smartphone does not support Bluetooth connection to the Mic, or if you are using an iPhone or iPad with a karaoke app to record your performance, you may use the provided USB Audio In Cable to connect the micro USB AUDIO IN jack of the Mic to the headphone jack of your smartphone/iPhone/iPad instead. The Mic controls and speaker connection will work in the same manner as in the Bluetooth connection mode.

### CONNECTING TO AN EXTERNAL AUDIO PLAYER

Use the provided USB Audio In Cable to connect the micro USB AUDIO IN jack of the Mic to the headphone jack of your external audio device such as a MP3 or MP4 player. The Mic controls and speaker connection will work in the same manner as in the Bluetooth connection mode.

### TO RECORD A LIVE PERFORMANCE

If the app of your smart device supports live recording of your performance, you can activate the feature and your performance will be recorded by the app locally on your device or on the server of your app. Please refer to your app for further optional sound effect settings and correct operation.

## CARE AND MAINTENANCE

1. Clean your Mic and Speaker units with a damp (never wet) cloth. Solvent or detergent should never be used.
2. Avoid leaving your unit in direct sunlight or in hot, humid or dusty places.
3. Keep your unit away from heating appliances and sources of electrical noise such as fluorescent lamps or motors.
4. Unplug all cables from the Mic and Speaker unit after use and store them properly to prevent accidental damage.

## TROUBLESHOOTING GUIDE

If you experience difficulties in the use of this mobile karaoke microphone please check the following or call 1-800-777-5331 for Customer Service.

PROBLEM	POSSIBLE CAUSE	SOLUTION
The power indicator of the Mic or Speaker does not light	Battery is exhausted	Recharge the battery with the provided micro USB cable.
No sound output from Speaker	Volume control of your external device is set to minimum.	Turn up the volume of your device.
	Mic Volume is set to minimum	Turn up the Mic volume.
	Speaker is not turned On.	Set Speaker On/Off Switch to On.
No echo effect	Echo Effect Control is set to minimum.	Turn up the Echo Effect Control of the Mic.
Cannot record sound	Not connected to the smart device properly by Bluetooth and/or USB Audio In cable	Check and make sure the connection of your smart device to the Mic is correct.
	Recording function is not set on your smart device	Set recording function properly on the app of your smart device

## SPECIFICATIONS

### Bluetooth Microphone:

Bluetooth :	Bluetooth v4.0 + EDR
Transmission Range :	Up to 30 feet (10 meters)
Sensitivity :	-46 dB/Pa at 1 kHz
Output Impedance :	2.2 kΩ
Polar Pattern :	Cardioid at 45 degrees at the front of the mic
Battery :	3.7V 600mAh (Built-in, Li-polymer rechargeable battery)
DC Input :	DC5V $\overline{=}$ 0.5A
Size :	5.18 x 1.40 x 1.28 inches / 131.5 x 35.5 x 32.5 mm
Weight :	2.65 oz / 75 grams

### Speaker Unit:

Output Power :	2.2W
Frequency Response :	100 Hz ~ 18 kHz
Distortion :	1%
SNR :	Better than 65 dB
Battery :	3.7V 600mAh (Built-in, Li-polymer rechargeable battery)
DC Input :	DC5V $\overline{=}$ 0.5A
Size :	3.65 x 3.27 x 1.93 inches / 92.5 x 83 x 49 mm
Weight :	5.46 oz / 155 grams

Due to continuing improvement, the features and design of this product are subject to change without notice.

The Bluetooth® word mark and logos are registered trademarks owned by Bluetooth SIG, Inc. and any use of



such marks by Spectra Merchandising Intl, Inc. is under license. Other trademarks and trade names are those of their respective owners.

iPhone, iPad, iOS and Mac OS X are trademarks of Apple Inc., registered in the U.S. and other countries. Android and Google Play are trademarks of Google Inc.

Windows is a registered trademark of Microsoft Corporation in the United States and/or other countries.

**Karaoke Night products are designed and engineered by Marino Andriani, LLC**

## **90 DAY LIMITED WARRANTY AND SERVICE VALID IN THE U.S.A. ONLY**

SPECTRA MERCHANDISING INTERNATIONAL, INC. warrants this unit to be free from defective materials or factory workmanship for a period of 90 days from the date of original customer purchase and provided the product is utilized within the U.S.A. This warranty is not assignable or transferable. Our obligation under this warranty is the repair or replacement of the defective unit or any part thereof, except batteries, when it is returned to the SPECTRA Service Department, accompanied by proof of the date of original consumer purchase, such as a duplicate copy of a sales receipt.

You must pay all shipping charges required to ship the product to SPECTRA for warranty service. If the product is repaired or replaced under warranty, the return charges will be at SPECTRA's expense. There are no other express warranties other than those stated herein.

This warranty is valid only in accordance with the conditions set forth below:

1. The warranty applies to the SPECTRA product only while:
  - a. It remains in the possession of the original purchaser and proof of purchase is demonstrated.
  - b. It has not been subjected to accident, misuse, abuse, improper service, usage outside the descriptions and warnings covered within the user manual or non-SPECTRA approved modifications.
  - c. Claims are made within the warranty period.
2. This warranty does not cover damage or equipment failure caused by electrical wiring not in compliance with electrical codes or SPECTRA user manual specifications, or failure to provide reasonable care and necessary maintenance as outlined in the user manual.
3. Warranty of all SPECTRA products applies to residential use only and is void when products are used in a nonresidential environment or installed outside the United States.

This warranty gives you specific legal rights, and you may also have other rights which vary from state to state. TO OBTAIN SERVICE please remove all batteries (if any) and pack the unit carefully and send it freight prepaid to SPECTRA at the address shown below. IF THE UNIT IS RETURNED WITHIN THE WARRANTY PERIOD shown above, please include a proof of purchase (dated cash register receipt) so that we may establish your eligibility for warranty service and repair of the unit without cost. Also include a note with a description explaining how the unit is defective. A customer service representative may need to contact you regarding the status of your repair, so please include your name, address, phone number and email address to expedite the process.

IF THE UNIT IS OUTSIDE THE WARRANTY PERIOD, please include a check for **\$25.00** to cover the cost of repair, handling and return postage. All out of warranty returns must be sent prepaid.

It is recommended that you contact SPECTRA first at 1-800-777-5331 or by email at [custserv@spectraintl.com](mailto:custserv@spectraintl.com) for updated information on the unit requiring service. In some cases the model you have may be discontinued, and SPECTRA reserves the right to offer alternative options for repair or replacement.

SPECTRA MERCHANDISING INTERNATIONAL, INC.  
4230 North Normandy Avenue,  
Chicago, IL 60634, USA.  
1-800-777-5331

To register your product, visit the link below to enter your information.  
<http://www.spectraintl.com/wform.htm>

0315

Printed in China