

*Studebaker*

# Joggable Personal CD Player with FM PLL Radio

## SB3703 OWNER'S MANUAL



Please read this Instruction Manual carefully before using  
the unit and retain it for future reference

B

## COMPLIANCE WITH FCC REGULATIONS

This device complies with Part 15 of the FCC Rules. Operation is subject to the following two conditions:

- (1) This device may not cause harmful interference, and
- (2) This device must accept any interference received, including interference that may cause undesired operation.

This equipment has been tested and found to comply with the limits for a Class B Digital Device, pursuant to Part 15 of the FCC Rules. These limits are designed to provide reasonable protection against harmful interference in a residential installation. This equipment generates, uses and can radiate radio frequency energy and, if not installed and used in accordance with the instructions, may cause harmful interference to radio communications. However, there is no guarantee that interference will not occur in a particular installation. If this equipment does cause harmful interference to radio or television reception, which can be determined by turning the equipment off and on, the user is encouraged to try to correct the interference by one or more of the following measures:

- Reorient or relocate the receiving antenna.
- Increase the separation between the equipment and receiver.
- Connect the equipment into an outlet on a circuit different from that to which the receiver is connected.
- Consult the dealer or an experienced radio/TV technician for help.

### WARNING

**Changes or modifications to this unit not expressly approved by the party responsible for compliance could void the user's authority to operate the equipment.**

## CAUTION

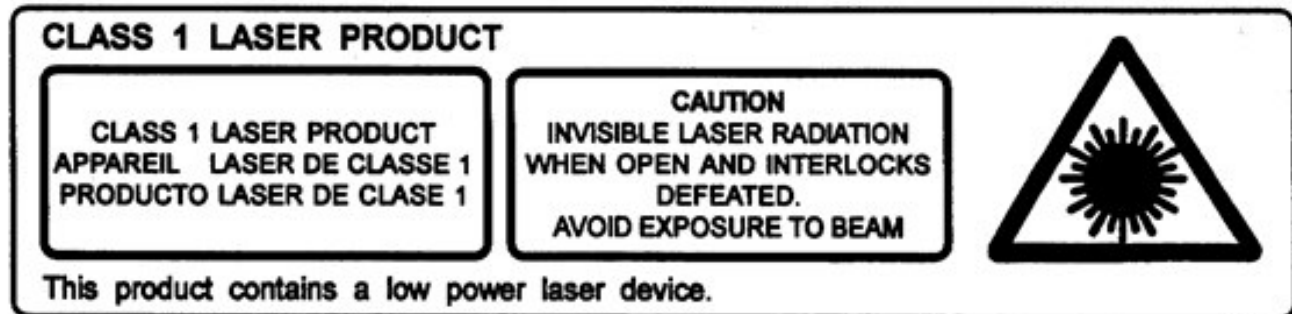

Follow the advice below for safe operations.

### ON PROTECTION AGAINST LASER ENERGY EXPOSURE

- As the laser beam used in this compact disc player is harmful to the eyes, do not attempt to disassemble the casing.
- Stop operation immediately if any liquid or solid object should fall into the cabinet.
- Do not touch the lens or poke at it. If you do, you may damage the lens and the player may not operate properly.
- Do not put anything in the safety slot. If you do, the laser diode will be ON when the CD door is still open.
- If the unit is not to be used for a long period of time, make sure that all power sources are disconnected from the unit. Remove all batteries from the battery compartment.
- This unit employs a laser. The use of controls or adjustment or performance of procedures other than those specified here may result in exposure to hazardous radiation.

Should any trouble occur, remove the power source and refer servicing to qualified personnel.

## PROTECT YOUR FURNITURE

This system is equipped with non-skid rubber 'feet' to prevent the product from moving when you operate the controls. These 'feet' are made from non-migrating rubber material specially formulated to avoid leaving any marks or stains on your furniture. However certain types of oil based furniture polishes, wood preservatives, or cleaning sprays may cause the rubber 'feet' to soften and leave marks or a rubber residue on the furniture.

To prevent any damage to your furniture we strongly recommend that you purchase small self-adhesive felt pads, available at hardware stores and home improvement centers everywhere and apply these pads to the bottom of the rubber 'feet' before you place the product on fine wooden furniture.

## DEAR STUDEBAKER CUSTOMER

Selecting fine audio equipment such as the unit you've just purchased is only the start of your musical enjoyment. Now it's time to consider how you can maximize the fun and excitement your equipment offers. This manufacturer and the Electronic Industries Association's Consumer Electronics Group want you to get the most out of your equipment by playing it at a safe level. One that lets the sound come through loud and clear without annoying blaring or distortion and, most importantly, without affecting your sensitive hearing. Sound can be deceiving. Over time your hearing "comfort level" adapts to higher volumes of sound. So what sounds "normal" can actually be loud and harmful to your hearing. Guard against this by setting your equipment at a safe level BEFORE your hearing adapts.

### To establish a safe level:

- Start your volume control at a low setting.
- Slowly increase the sound until you can hear it comfortably and clearly, and without distortion.
- Once you have established a comfortable sound level: Set the dial and leave it there.

Taking a minute to do this now will help to prevent hearing damage or loss in the future.

After all, we want you listening for a lifetime.

### We Want You Listening For a Lifetime

Used wisely, your new sound equipment will provide a lifetime of fun and enjoyment. Since hearing damage from loud noise is often undetectable until it is too late, this manufacturer and the Electronic Industries Association's Consumer Electronics Group recommend you avoid prolonged exposure to excessive noise.



### Customer's Record:

The serial number of this product is found on its bottom cover. You should note the serial number of this unit in the space provided as a permanent record of your purchase to aid in identification in the event of theft or loss.

Model Number: SB3703

Serial Number:

## LOCATION OF CONTROLS

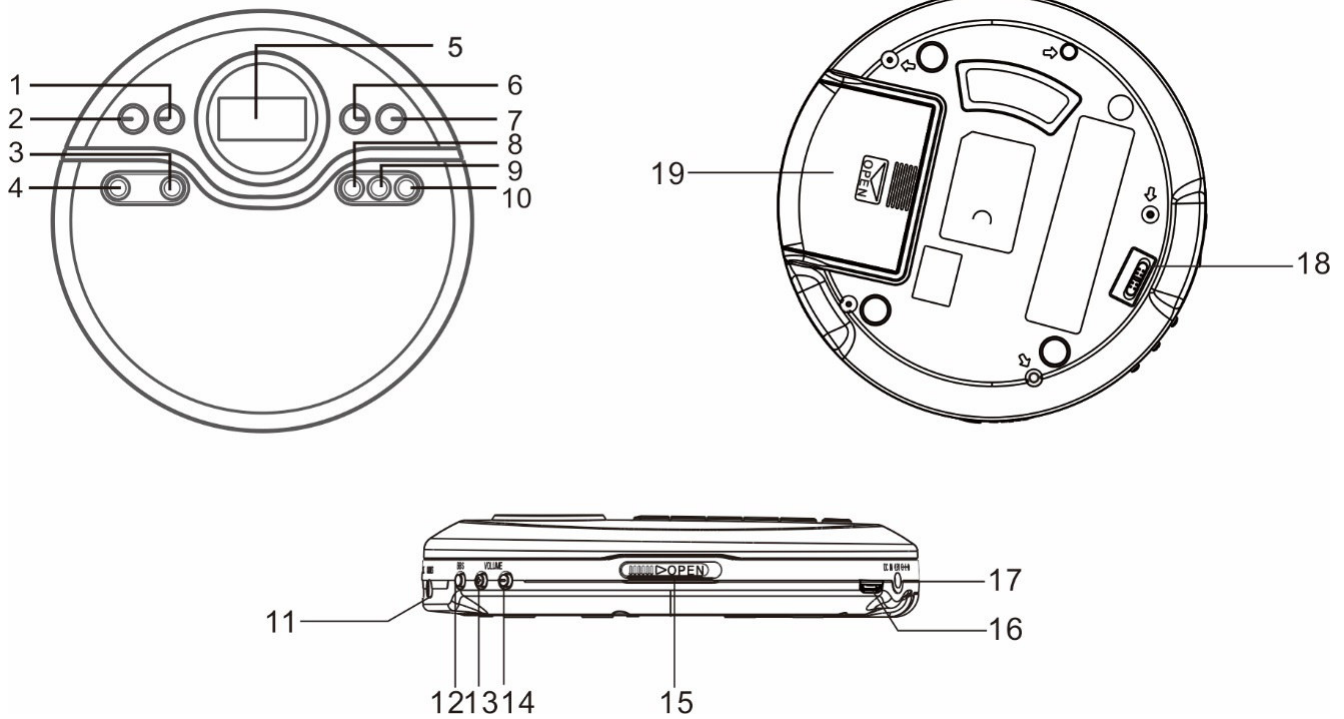

- |   |   |
|---|---|
| <p>1 TUNER ▲ / ►►   BUTTON</p> <p>2 TUNER ▼ /   ◄◄ BUTTON</p> <p>3 PRESET / 10/FOLDER ▲ BUTTON</p> <p>4 PRESET / 10/FOLDER ▼ BUTTON</p> <p>5 LCD DISPLAY</p> <p>6 POWER OFF / CD ■ BUTTON</p> <p>7 POWER ON / CD ►   BUTTON</p> <p>8 PROGRAM / MODE BUTTON</p> <p>9 A-B BUTTON</p> <p>10 CD/FM BUTTON</p> | <p>11 EARPHONES JACK</p> <p>12 BBS ON/OFF BUTTON</p> <p>13 VOLUME +</p> <p>14 VOLUME -</p> <p>15 CD DOOR OPEN SWITCH</p> <p>16 USB POWER JACK</p> <p>17 DC IN JACK</p> <p>18 HOLD SWITCH</p> <p>19 BATTERY DOOR</p> |
|---|---|

## POWER SOURCE

### BATTERY OPERATION

Notes: Disconnect AC adapter before installing batteries.

For best performance and longer operating time, we recommend the use of alkaline batteries.

1. Remove the BATTERY DOOR (#19) on the bottom of the unit.
2. Follow the polarity diagram shown in the BATTERY COMPARTMENT to insert 2 X 'AA' size (UM-3) batteries and close the BATTERY DOOR (#19).

### BATTERY WARNING

1. Be sure that the batteries are installed correctly. Wrong polarity may damage the unit.
2. Use only the size and type of batteries specified.
3. Do not mix old and new batteries.
4. Do not mix alkaline, standard (carbon-zinc) or rechargeable (nickel-cadmium) batteries.
5. If the unit is not to be used for an extended period of time, remove the batteries. Old or leaking batteries can cause damage to the unit and may void the warranty.
6. Do not try to recharge batteries not intended to be recharged; they can overheat and rupture. (Follow battery manufacturer's directions).
7. Do not dispose of batteries in fire, batteries may leak or explode.

### AC ADAPTER (not included) OPERATION

(AC adapter: input AC 120V ~ 60Hz, output DC 4.5V --- 700mA)

1. Plug the AC adapter (not included) into normal AC power outlet socket.
2. Insert the DC plug of the AC adapter cord into the DC IN JACK (#17).
3. When the unit is operated using AC adapter, the battery source will automatically be disconnected.

**WARNING:** Before connecting to the power supply, ensure that the supply corresponds to the information on the rating label at the back of the apparatus.

### USB POWER

- The SB4703 can be operate by USB power DC 5V --- 500mA.
- Plug one end (micro USB plug) of the USB cable into the USB POWER JACK (#16) and the other end of the cable to the USB charger/power bank/computer (not included).
- When the unit is operated using USB power, the battery source will automatically be disconnected.

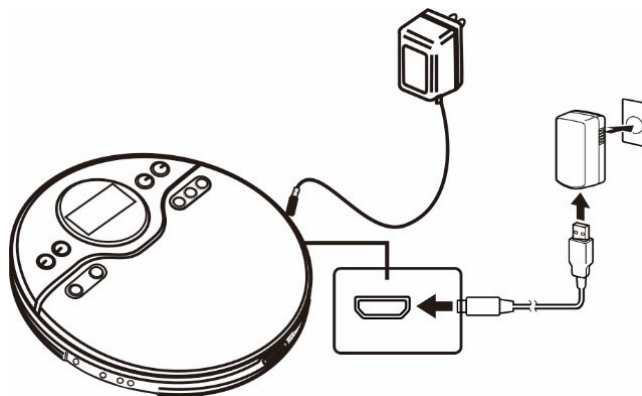

## EARPHONES CONNECTION

Connect the plug of the stereo earphone (included) into the EARPHONES JACK (#11).

### CAUTION

- Avoid excessive volume levels for long period of time when using the earphones. Prolonged use at high levels may impair your hearing.
- Do not use earphones while operating a motorized vehicle, as it may create a traffic hazard and is illegal in many areas

## CD/MP3 CD OPERATION

### PLEASE READ THIS IMPORTANT INFORMATION:

CD mechanisms used in devices like this are designed to fully read all commercial CDs. They will also read self-compiled CD-R/CD-RW discs but it may take up to 10 seconds for playback to start. If playback does not start, it is likely due to the quality of the CD-R/RW disc and/or the compatibility of the CD compilation software. Manufacturer is not responsible for the playback quality of CD-R/RW discs.

Do not attach a label or seal to either side of the CD-R/RW disc. It may cause a malfunction.

### FOR WINDOWS USERS:

When using the “Burn a CD” feature to create an MP3 CD in Windows, you must select the “With a CD/DVD player” option when it asks “How do you want to use the disc?” The MP3 CD will not play on this unit if you select the “Like a USB flash drive” option or if the MP3 CD is not finalized.

### PLAYING A COMMERCIAL CD

1. Tap the POWER ON BUTTON (#7) to turn on the unit.
2. Tap the CD/FM BUTTON (#10) to select CD mode if necessary.
3. Slide the CD DOOR OPEN SWITCH (#15) to open the CD door. Carefully place an audio CD with its label side upward in the CD compartment and close the CD door.
4. The CD will spin and start reading the disc information. When finished, the LCD DISPLAY (#5) will show the total time and number of tracks on the CD.
5. Press the CD ►|| BUTTON (#7) to start playing the CD.
6. While playing, press the CD ►|| BUTTON (#7) to pause playback. The current track number will be flashing on the display. Press the CD ►|| BUTTON (#7) again to resume playing.
7. Tap the VOLUME + / - BUTTONS (#13 / #14) to obtain the desired volume level.
8. You can choose to play your favorite track directly by pressing either the ►|| or ◀◀◀ BUTTONS (#1 or #2) repeatedly until correct track number selected.
9. To locate a particular passage within a track, keep the ►|| or ◀◀◀ BUTTONS (#1 or #2) and depressed until it is found.

**Note:** Low level audio will be heard during the search process to assist in locating correct point in the track.

10. To stop playing, tap the STOP ■ BUTTON (#6).
11. Press and hold the POWER OFF BUTTON (# 6) to turn off the unit.



## **REPEAT MODE PLAYING A COMMERCIAL CD**

### **REPEAT 1:**

When you first start playing a CD, press the MODE BUTTON (#8) once and “REP 1” show on the LCD DISPLAY (#5). The current track playing will now repeat continuously until you stop playback or change the mode.

### **REPEAT ALL:**

Press the MODE BUTTON (#8) again and “REP ALL” will show on the LCD DISPLAY (#5). All tracks on the CD will play in order and will repeat continuously until you stop playback or change the mode.

### **RANDOM PLAY:**

Press the MODE BUTTON (#8) again and “RND” will show on the LCD DISPLAY (#5). All tracks on the CD will play in random order until you stop playback or change the mode.

### **CANCELLING THE REPEAT MODES:**

Press the MODE BUTTON (#8) again or until all the symbols on the LCD DISPLAY (#5) turn off.

## **PLAYING A MP3 CD**

1. Tap the POWER ON BUTTON (#7) to turn on the unit.
2. Tap the CD/FM BUTTON (#10) to select CD mode if necessary.
3. Slide the CD DOOR OPEN SWITCH (#15) to open the CD door. Carefully place an CDMP3 with its label side upward in the CD compartment and close the CD door
4. The CD will spin and start reading the disc information. When finished, the LCD DISPLAY (#5) will show the total number tracks followed by the total number of folders on the MP3 CD.
5. Press the ►|| BUTTON (#7) to start playing the MP3 CD.
6. While playing, press the PLAY/PAUSE ►|| BUTTON (#7) to pause playback. The current track number will be flashing on the LCD DISPLAY (#5). Press the PLAY/PAUSE ►|| BUTTON (#7) again to resume playing.
7. Pressing the FOLDER ▲/▼ BUTTON (#3/#4) allows you to switch folders (if available on your MP3 CD). Repeatedly press the FOLDER ▲/▼ BUTTON (#3/#4) to step through all the available folders on the MP3 CD. The LCD DISPLAY (#5) will show F01 is folder #1, F02 is folder #2 and so on.
8. Adjust the VOLUME +/- BUTTONS (#13/14) to obtain the desired volume level.
9. Press the CD STOP ■ BUTTON (#6) to stop playing.
10. Press and hold the POWER OFF BUTTON (#6) to turn off the unit.

## **REPEAT MODE PLAYING AN MP3 CD**

### **REPEAT 1:**

When you first start playing an MP3 CD, press the MODE BUTTON (#8) once and “REP 1” will show on the display. The current track playing will now repeat continuously until you stop playback or change the mode.

### **REPEAT FOLDER (ALBUM):**

Press the MODE BUTTON (#8) again and “REP DIR(FOLDER)” appears on the LCD DISPLAY (#5). Repeatedly press the FOLDER ▲/▼ BUTTON (#3/#4) to step through all the available folders and select the folder you want to reply. All tracks in that folder will play in order and will repeat continuously until you stop playback or change the mode.

**REPEAT ALL:**

Press the MODE BUTTON (#8) again and "REP ALL" appears on the display. All tracks on the CD will play in order and will repeat continuously until you stop playback or change the mode.

**RANDOM PLAY:**

Press the MODE BUTTON (#8) again and "RND" appears on the display. All tracks on the CD will play in random order until you stop playback or change the mode.

**CANCELLING THE REPEAT MODES:**

Press the MODE BUTTON (#8) again or until all the symbols on the display turn off.

**SKIP AND SEARCH MODE (COMMERCIAL CD and MP3 CD)**

1. During Play or Pause mode, press the ►► BUTTON (#1) or ◀◀ BUTTON (#2) to go to the next track or go back to the beginning of the current track.
2. During play mode or Pause mode, press and hold the + ►► BUTTON (#1) or ◀◀ BUTTON (#2) to search within the current track with audible high-speed playback.

**PROGRAM PLAY MODE (COMMERCIAL CD and MP3 CD)**

This function allows the tracks to be played in a programmed sequence. Programs can be set in STOP mode.

1. Tap the PROG BUTTON (#8) once. The "P-01 XX" will show on the LCD DISPLAY (#5). The track number "XX" will blink to prompt for input.
2. Tap the ►► or ◀◀ BUTTONS (#1/#2) repeatedly to select the track to be programmed. (For a MP3 CD, the folder number will show on the left of the LCD DISPLAY)
3. Tap the PROG BUTTON (#8) again to store selection. The Program Channel No. will change to "P-02" and the track number "XX" will blink to prompt for input.
4. You may repeat steps 2 - 3 to program up to 24 tracks for CD or 99 tracks for MP3 CD.
5. Tap PLAY/PAUSE ►|| BUTTON (#7) to start the programmed play.
6. You may repeat the current programmed track or all programmed tracks by pressing the MODE BUTTON (#8) once or twice at programmed play mode.
7. Tap STOP ■ BUTTON (#6) once to stop playback.
8. Tap PLAY/PAUSE ►|| BUTTON (#7) to resume programmed play.
9. To cancel programmed play, press the STOP ■ BUTTON (#6) twice.

**A-B REPEAT PLAYBACK**

1. During CD or MP3 CD playback, press REPEAT A-B BUTTON (#9) at the point where you want to set the starting time of the A-B playback. "A SEt" is displayed on the LCD DISPLAY (#5) and return to show the track time after 3 seconds.
2. Press REPEAT A-B BUTTON (#9) at the point where you want to set the end time of the A-B playback. "On Ab" is displayed on the LCD DISPLAY (#5) and return to show the track time after 3 seconds. "A-B" will display on the upper right corner of the LCD DISPLAY (#5) and the selected period (A to B) will playback repeatedly.
3. Tap the STOP ■ BUTTON (#6) to clear the A-B repeat playback setting and stop playback. Or tap A-B BUTTON (#9) to cancel the A-B repeat and carry on the playback.



## AUTOMATIC RESUME FUNCTION

If the CD Player turns off during playback due to power failure or the CD door accidentally being opened, you can resume playback from the same position after restarting the unit or closing the CD door again. Auto resume also works if you turn the CD Player off and want to continue listening at a later time.

## ANTI-SHOCK PROTECTION

This player incorporates an electronic anti-skip circuit to prevent interruption of the sound output when the unit is subjected to shock, vibration or rolling during CD playback. The anti-shock system will automatically activate when a disc is playing, the ESP indicator will appear on the LCD DISPLAY (#5).

Once the anti-skip buffer is full, it will give you approximately 60 seconds of protection against interruption of sound output. If the player is subjected to shock or rolling for longer than the buffer memory, some interruption of sound output will occur. This is normal and to be expected and the sound will resume once the player has stabilized from the shock or rolling disturbance.

**Note:** The anti-skip function provides for continuous sound output when the unit is subjected to shock or vibration. It will not compensate for errors arising from the use of defective, scratched or dirty discs.

## RADIO OPERATION

1. Tap POWER ON BUTTON (#7) to turn on the unit.
2. Tap the CD/FM BUTTON (#10) once to select FM mode when the unit is at CD mode, the FM radio frequency appears on the LCD DISPLAY (#5).
3. To manually tune to a specific radio station, tap the TUNER ▲ or ▼ BUTTON (#1 or #2) repeatedly. Use the manual tuning method to tune in weaker stations that are bypassed during Automatic Tuning.
4. To automatically tune to the next available radio station, press and hold the TUNER ▲ or ▼ BUTTON (#1 or #2) for 1-2 seconds until frequency readout on the display begins to scan and then release the button. The tuner will stop scanning when it receives the next broadcasting station of adequate signal strength.
5. Press the volume control VOLUME +/- BUTTON (#13/#14) to the desired volume level.

### TIPS FOR BEST RECEPTION

The headphones cord acts as an aerial and must be fully extended for best reception.

### PRESET RADIO STATIONS

1. Tap POWER ON BUTTON (#7) to turn on the unit.
2. Tap the CD/FM BUTTON (#10) to enter FM mode when the unit is at CD mode, the FM radio frequency appears on the LCD DISPLAY (#5).
3. Tune to the desired radio station either by "manually" or "automatically" tuning method.
4. Tap the PROGRAM/ MODE BUTTON (#8), the preset memory number flash on the LCD DISPLAY (#5). (Note: P01 will blink in the display if you are programming preset for first time).
5. Tap the PRESET ▲ or ▼ BUTTON (#3/#4) repeatedly to select the preset number you want to assign the station to.

6. Tap the PROG BUTTON (#8) to confirm the setting.
7. Repeat above steps 3 - 6 to preset up to 30 FM stations.

#### RECALLING PRESET RADIO STATIONS

Press the PRESET ▲ or ▼ BUTTON (#3/#4) repeatedly to select the desired station is located.

### BBS FUNCTION

Tap the BBS ON/OFF BUTTON (#12) to turn on the BBS to enhance the bass effect of the music. Tap again to turn off the BBS.

### HOLD FUNCTION

To prevent accidental function changes during active use, this unit is fitted with a function hold. After the unit has been powered on and playing in CD or FM mode, slide the HOLD SWITCH (#18) to ON position. HOLD INDICATOR will show on the LCD display (#5).

### RESETTING THE UNIT

In case of malfunction due to electrostatic discharge, reset the unit by disconnecting the DC plug of the AC Adapter from its rear DC IN JACK (#17) and remove the batteries. Wait at least for 3 minutes before reconnecting the DC plug to the DC IN JACK (#17) or insert the batteries.

### CARE AND MAINTENANCE

1. Clean your unit with a damp (never wet) cloth. Solvent or detergent should never be used.
2. Avoid leaving your unit in direct sunlight or in hot, humid or dusty places.
3. Keep your unit away from heating appliances and sources of electrical noise such as fluorescent lamps or motors.
4. If drop-outs or interruptions occur in the music during CD play, or if the CD fails to play at all, its bottom surface may require cleaning. Before playing, wipe the disc from the center outwards with a good soft cleaning cloth.



## TROUBLE SHOOTING GUIDE

If you experience difficulties in the use of this clock radio, please check the following or call 1-800-777-5331 for Customer Service and support.

SYMPTOM	POSSIBLE	SOLUTION
No sound	Battery no power	Replace all batteries with new ones.
	Volume set at minimum	Increase Volume.
Noise or sound distorted on FM broadcast	Earphone cord is not extended	Extend earphone cord
Radio no sound	Unit not in RADIO(FM) mode	Switch to FM mode
	Station unstable	Retune the station again
CD player will not play	Unit not in CD mode	Switch to CD mode
	CD is installed incorrectly	Insert CD with label side up.
	Batteries become exhausted	Replace all batteries with new ones.
	If the CD is self-compiled, the media used may not be compatible with the player.	Use better quality blank media and retest.
CD skips while playing	Disc is dirty or scratched.	Wipe CD with clean cloth or use another disc.
	Dirty or defective disc	Clean or replace the defective disc
	Dirty pick up lens	Use a CD-lens cleaning disc to clean the lens
	Player is subject to excessive shock or vibration	Relocate the player away from shock or vibration
CD skips while playing	Batteries become exhausted	Replace all batteries with new ones.

## SPECIFICATION

Power Requirement	Battery: 2 x "AA"(UM-3) batteries (not included) AC Adaptor (not included): Input: AC 120V ~ 60Hz Output: DC 4.5V --- 700mA USB Power: DC 5V --- 500mA
FM Frequency	87.5 Mhz – 108 Mhz

## 1 YEAR LIMITED WARRANTY AND SERVICE VALID IN THE U.S.A. ONLY

SPECTRA MERCHANDISING INTERNATIONAL, INC. warrants this unit to be free from defective materials or factory workmanship for a period of 1 year from the date of original customer purchase and provided the product is utilized within the U.S.A. This warranty is not assignable or transferable. Our obligation under this warranty is the repair or replacement of the defective unit or any part thereof, except batteries, when it is returned to the SPECTRA Service Department, accompanied by proof of the date of original consumer purchase, such as a duplicate copy of a sales receipt.

You must pay all shipping charges required to ship the product to SPECTRA for warranty service. If the product is repaired or replaced under warranty, the return charges will be at SPECTRA's expense. There are no other express warranties other than those stated herein.

This warranty is valid only in accordance with the conditions set forth below:

1. The warranty applies to the SPECTRA product only while:
  - a. It remains in the possession of the original purchaser and proof of purchase is demonstrated.
  - b. It has not been subjected to accident, misuse, abuse, improper service, usage outside the descriptions and warnings covered within the user manual or non-SPECTRA approved modifications.
  - c. Claims are made within the warranty period.
2. This warranty does not cover damage or equipment failure caused by electrical wiring not in compliance with electrical codes or SPECTRA user manual specifications, or failure to provide reasonable care and necessary maintenance as outlined in the user manual.
3. Warranty of all SPECTRA products applies to residential use only and is void when products are used in nonresidential environment or installed outside the United States.

This warranty gives you specific legal rights, and you may also have other rights which vary from state to state. TO OBTAIN SERVICE please remove all batteries (if any) and pack the unit carefully and send it freight prepaid to SPECTRA at the address shown below. IF THE UNIT IS RETURNED WITHIN THE WARRANTY PERIOD shown above, please include a proof of purchase (dated cash register receipt) so that we may establish your eligibility for warranty service and repair of the unit without cost. Also include a note with a description explaining how the unit is defective. A customer service representative may need to contact you regarding the status of your repair, so please include your name, address, phone number and email address to expedite the process.

It is recommended that you contact SPECTRA first at 1-800-777-5331 or by email at [custserv@spectraintl.com](mailto:custserv@spectraintl.com) for updated information on the unit requiring service. In some cases, the model you have may be discontinued, and SPECTRA reserves the right to offer alternative options for repair or replacement.

SPECTRA MERCHANDISING INTERNATIONAL, INC.

4230 North Normandy Avenue,

Chicago, IL60634, USA. 1-800-777-5331

To register your product, visit the link on the website below to enter your information.

<http://www.spectraintl.com/wform.htm>